

# Surveyor HD-Pro

## Subsea Wide-Angle Colour Zoom HD Video Camera

The Bowtech Surveyor HD-Pro is a premium wide-angle, high-definition (HD) video camera. It has a 30:1 zoom feature and is designed to carry out extremely detailed video inspection work with its close-up video capabilities.

The user will benefit from the camera's 100° wide viewing angle and range of light sensitivity controls, including manual and automatically adjustable focus and iris settings, white balance, auto tracking and back light compensation. The advanced feature set comes complete with a wide dynamic range to maximise the camera's video quality in a low-light environment.

The Surveyor HD-Pro camera is rated to 6,000m with an optically water-corrected hemispherical window made of fused silica. The titanium housing is offered with a choice of subsea connectors, wiring configurations and HD-SDI over coax or fibre optic video output.

The adjustable functions offered with this feature-packed camera can be controlled by a single wire/tristate/Bluetooth or via a Bowtech GUI software (USB stick) and user selectable RS-232/RS-485 coms interface connected either to a laptop or PC.



This premium quality, high-performance subsea camera is ideal for colour inspection and observation tasks and is part of a family of products that produces detailed video images for use on many different types of subsea applications and vehicles across the world's oceans.

Please contact a member of our sales team to discuss your specific requirements when ordering this camera, including connector, and wiring configuration.

### PRODUCT FEATURES AND BENEFITS

- Easy to use high-specification HD camera ideal for subsea video inspection work
- Durable, high-quality 6000m rated titanium housing
- Selectable HD formats for different output requirements
- 30:1 optical zoom feature for great close-up details
- HD over coax or fibre optic video output options
- Wide-angle water-corrected optics for accurate post-processing photogrammetry work



**TELEDYNE MARINE**  
BOWTECH  
Everywhereyoulook™

# Surveyor HD-Pro

Subsea Wide-Angle Colour Zoom HD Video Camera



## TECHNICAL SPECIFICATIONS

<b>Electrical</b>	Nominal voltage	24Vdc (11Vdc to 30Vdc)
	Current at nominal voltage	0.4A
	Power	9.6W
	Video output	HD-SDI over coax, HD-SDI over fibre
	Connectors	Contact for options
	Control method	Bluetooth (not for subsea use), RS-232, RS-485, Tristate, 2-wire bipolar
<b>Optical</b>	Sensor	1/2.8"
	Resolution	1920 x 1080 pixels (max.)
	Sensitivity	0.01lx (scene)
	Active pixels	2.13MP
	Signal to noise ratio	>50dB
	Lens	Wide/tele: 4.3-129.0mm @ F1.6-F4.7
<b>Mechanical</b>	Optical zoom	30:1
	Angle of view in water	Diagonal: 100°, horizontal: 92°, vertical: 61°
	Housing/window	Titanium grade 5/fused silica
	Dimensions	Ø138mm (retainer), Ø112.5mm (body) x 232.6mm length (excl. connector)
<b>Environmental</b>	Weight in air/water	5.4kg/2.5kg
	Water depth rating	6000m
	Storage temperature	-20 to +60°C
	Operating temperature	-5 to +50°C
	Shock	3 axis (operating), 30g peak, 6ms half sine pulse
	Vibration	3 axis (operating), 10g, 20 to 150Hz
	EMC	BS EN IEC 61000-6-4:2019, BS EN IEC 61000-6-2:2019, BS IEC 60533:2015
	RoHS	Directive 2011/65/EU

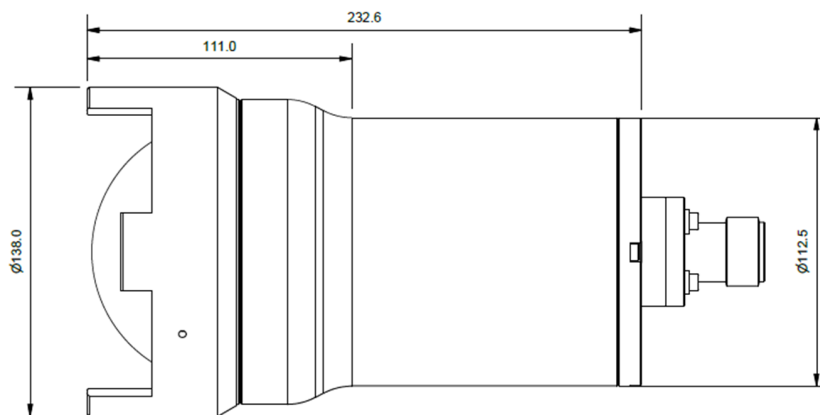

Product Dimensions (for reference only)



**TELEDYNE MARINE**  
BOWTECH  
Everywhereyoulook™

[www.teledynemarine.com/bowtech](http://www.teledynemarine.com/bowtech)

Tel. +44 (0)1224 772345

Email: [bowtech@teledyne.com](mailto:bowtech@teledyne.com)

